

Flange Nyloc Insert Nut

Thread Type: UNF - Fine

Thread Direction: Right Hand

Material: Carbon Steel

Class Grade: High Tensile Grade 5

Finish: Zinc Plated

Corrosion Protection Level: Moderate

Standard: DIN 6926

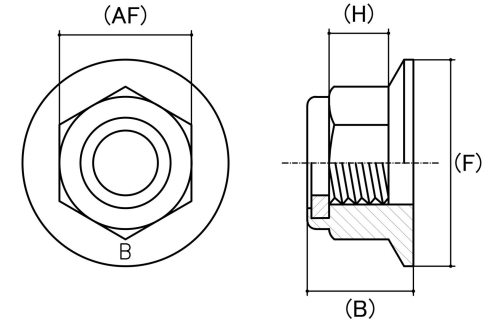

*CAD drawings shown for graphic representation only.**

Size	Thread Pitch (TPI)	Thread Type	Overall Nut Height (B) (mm)		Hex Height (H) (mm)	Flange Diameter (F) (mm)	Flange Thickness (D) (mm)	Across Flats (AF) (mm)		Spanner Size (AF) (inches)	sku (qfind)
			Min	Max	Nom	Nom	Nom	Min	Max		
1/4"	28	Fine	6.90	7.15	3.59	14.00	1.66	10.88	11.16	7/16	41FLNF14
3/8"	24	Fine	10.30	10.60	5.85	20.00	2.65	14.00	14.28	9/16	41FLNF38
1/2"	20	Fine	13.60	13.90	6.40	26.80	3.75	18.70	19.05	3/4	41FLNF12

Disclaimer:

Dimensional data and technical information was obtained from publically available sources and not acquired through standard agencies. It has been completed and compiled for reference purposes only; where discrepancies are found they are subject to change without notice. Bolt & Nut Australia makes no warranties or representations regarding the accuracy and validity of the compiled information and data. Contact the relevant standard authorities for accurate and detailed information.

* CAD drawings may not reflect diameter, thread length or overall length.

© Bolt & Nut Australia Pty Ltd. All rights reserved.

Version: 18 Mar 2024